

Along industrial memory
Tomomi Yamakawa
20.03. - 18.04.2026

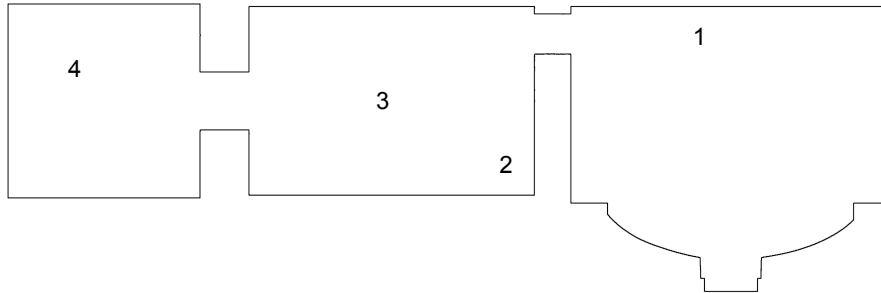

1 *I don't speak English*, 2026
150 x 90 x 2 cm,
acrylic and oil on canvas

3 *along industrial memory*, 2026
158,5 x 45 x 12,5 cm
wood, felt fabric, crowd control belt,
Match, box, incense stick, candle,
LED candle, LED incense stick, PVC
sweet, feather duster, player beads,
mirror sheet, LED strip, wax, metal
piece, etc.

2 *cloud control belt*, 2026
15 x 7 x 3 cm
silicone, staples

4 *gravity's gratitude*, 2026
dimensions variable
readymade pasta, plate, fork,
hourglass

“Butsudan” is a family Buddhist altar, it is like a dresser, a black box. It usually stays in Japanese households. There are some symbolic objects in the shelf, a tool for making noise, a candle holder, incense holder, match extinguisher, flower vase, a pot for tea, plates for fruit, rice and sweets.

I included some of the objects in the painting. They are on the beach instead of staying on the dark shelf. First I thought those ritualistic objects are not designed for our comfort and use in everyday life.

There are drawers that stock candles, incense sticks and reusable versions; LED candles, LED incense sticks which don't make smoke and rice, pastry offerings made out of plastic.

Wait, do they work in the ritualistic context still?

But actually I feel comfortable with the way too convenience culture.